

SPEEDSIGNAL PUSH BUTTONS/SWITCHES

Dimensions: 25x23 mm (width x height)

Material: Plastic material - black

Colour touch surface: black, red, green or yellow

Functional illumination (dot): yellow or red

Detection illumination (Theme): white

Customised themes possible

Drill hole:

21 mm

Panel Thickness:

0,8-3 mm

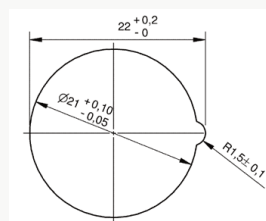

ELECTRICAL DATA:

Push Button:

Switching voltage: Max. 35 V
Switching current: Max. 100 mA
Switching capacity: Max. 1 W

Switch:

Switching voltage: Max. 16 V
Switching current: Max. 2 A



QUANTITIES & PRICES:

Minimum purchase with own motif: 10 pcs.

One-off costs for motif creation (provision of DXF-file): 75 €

One-off costs for motif creation (no DXF-file): 120 €

Prices push buttons (incl. cable C-3561205 - 800mm):

Up to 10 pcs: 28,50 €
10 pcs: 25,30 €
25 pcs: 22,70 €
50 pcs: 21,80 €
100 pcs: 20,75 €

Prices switches (incl. cable C-3561207 - 800mm):

Up to 10 pcs.: 34,50 €
10 pcs: 30,50 €
25 pcs: 28,57 €
50 pcs: 27,82 €
100 pcs: 26,64 €

All Prices are net plus taxes and shipping

MOTIFS:

